

DEVON® 大有

型号: **1324**
1324-18-12E

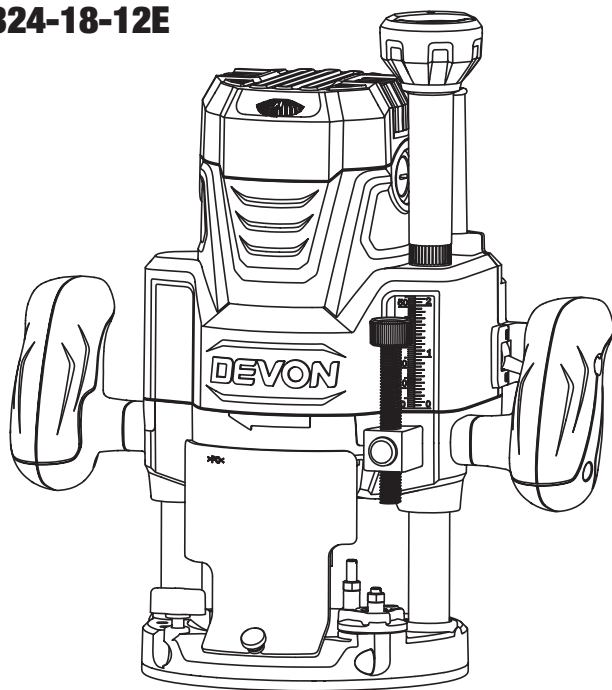

中国 电木铣

GB Electric Router

各产品外观之间存在差异，请以实物为准

专业电动工具

PROFESSIONAL TOOLS

大有工具 “劲”在掌握

电木铣简介



电木铣常用于木材、塑胶等材料上进行修边，也可以用来铣槽、雕刻、挖孔，或借助模板进行铣挖作业。

请您在使用前务必仔细阅读说明书，并严格按照说明指示使用产品！

1. 操作控制

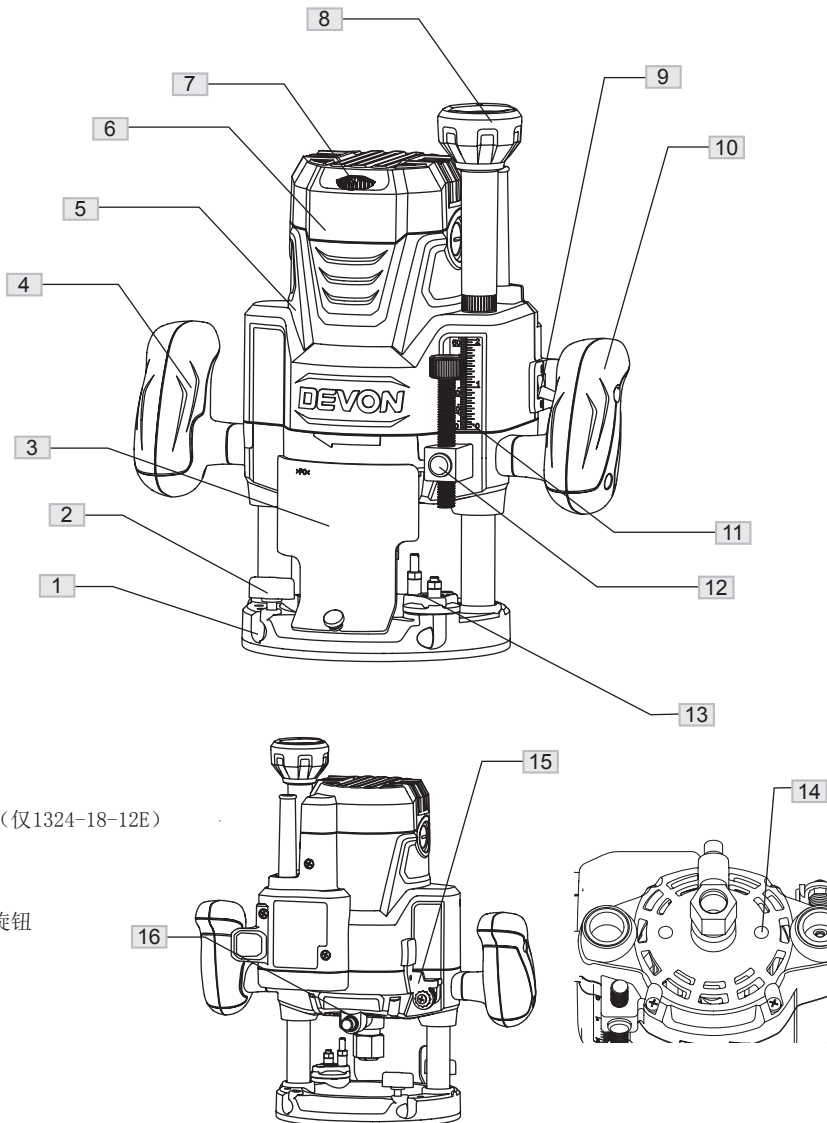

2. 工具规格

型号	1324	1324-18-12E
额定电压（伏）	220	220
额定频率（赫兹）	50	50
额定输入功率（瓦）	1750	1880
空载转速（转/分钟）	22000	9000-22000
夹头规格	1/2”、3/8”	1/2”、3/8”
微调刻度指示	有	有
调节深度指示	有	有
LED照明灯	有	有
恒定电子转速控制	无	有
刀头行程（毫米）	0-60	0-60
底板直径（毫米）	160	160
重量（公斤）	5.7	5.7
保护等级	□/II	□/II

注：1. 为求改进，本说明书所载规格可能不预先通告而给予更改。
2. 本说明书提供的参数是以220V为依据，若有低于或高于此电压的地区，数据有可能不同。

安全操作须知

⚠ 警告: 阅读所有警告和所有说明 没有按照以下列举的警告或说明而使用或操作将可能导致触电、着火和其他严重伤害。在以下所有列举的警告中，术语“电动工具”指市电驱动（有线）电动工具或蓄电池驱动（无线）电动工具。
保存这些说明。

1. 工作场地

- 1) 保持工作场地清洁和明亮。混乱和黑暗的场地会引发事故。
- 2) 不要在易爆环境，如有易燃液体、气体或粉尘的环境下操作电动工具。电动工具产生的火花会点燃粉尘或气体。
- 3) 让儿童和旁观者离开后操纵电动工具。分心会使您放松而失去控制。

2. 电气安全

- 1) 电动工具插头必须与插座相配。绝不能以任何方式改装插头。需接地的电动工具不能使用任何转换插头。未经改装的插头和相配的插座将减少触电危险。
- 2) 避免人体接触接地表面，如管道、散热片和冰箱。如果您身体接地会增加触电危险
- 3) 不得将电动工具暴露在雨中或潮湿环境中。

水进入电动工具将增加触电危险。

- 4) 不得滥用电线。绝不能用电线搬运、拉动电动工具或拔出其插头。让电动工具远离热、油、锐边或运动部件。受损或缠绕的电线会增加触电危险。
- 5) 当在户外使用电动工具时，使用适合户外使用的外接电线。适合户外使用的电线将减少触电危险。
- 6) 当在潮湿环境下使用该机器不可避免时，使用剩余电流装置（RCD）保护。剩余电流装置的使用可以减少触电的危险。

3. 人身安全

- 1) 保持警觉，当操作电动工具时关注所从事的操作并保持清醒。切勿在有疲倦，药物、酒精或治疗反应下操作电动工具。在操作电动工具期间精力分散会导致严重人身伤害。
- 2) 使用安全装置。始终配戴护目镜。安全装置，诸如适当条件下的防尘面具、防滑安全鞋、安全帽、听力防护等装置能减少人身伤害。
- 3) 避免突然起动。确保开关在插入插头时处于关断位置。手指放在已接通电源的开关上或开关处于接通时插入插头可能会导致危险。
- 4) 在电动工具接通之前，拿掉所有调节钥匙或扳手。遗留在电动工具旋转零件上的扳手或钥匙会导致人身伤害。

- 5) 手不要伸得太长。时刻注意脚下和身体平衡。这样在意外情况下能很好地控制电动工具。
- 6) 着装适当。不要穿宽松衣服或佩带饰品。让您的头发、衣服和袖子远离运动部件。宽松衣服、佩饰或长发可能会卷入运动部件。
- 7) 如果提供了与排屑装置、集尘设备连接用的装置，则确保他们连接完好且使用得当。使用这些装置可减少碎屑引起的危险。
- 8) 使用夹钳或其他方法将工件固定在平台上。用手握机器或将机器倚靠在身体上导致不平衡可引起失控。
- 9) 不要使用梯子或其他不稳定的支撑方法。在特殊情况下，稳固的立足使使用更好的控制机器。
- 10) 使手保持干燥，清洁，无油脂。带油的手可能导致失控。
- 11) 经常佩戴有侧面护罩的护目镜。日常戴的眼镜可能有防冲击的镜头，但它们不是安全护目镜。遵循该注意事项将减少眼睛伤害。
- 12) 保护您的呼吸器官。当有尘工作时，佩戴防尘面具。遵循该注意事项将减少严重的身体伤害。
- 13) 保护您的听觉。在长时间持续工作中，需佩戴耳塞。遵循该注意事项将减少严重的身体伤害。

4. 电动工具使用和注意事项

- 1) 不要滥用电动工具，根据用途使用适当的电动工具。选用适当的设计额定值的电动工具会使您工作更有效、更安全。
- 2) 如果开关不能接通或关断工具电源，则不能使用该电动工具。不能用开关来控制的电动工具是危险的且必须进行修理。
- 3) 在进行任何调节、更换附件或贮存电动工具之前，必须从电源上拔掉插头和/或将蓄电池盒断开电源。这种防护性措施将减少电动工具突然起动的危险。
- 4) 将闲置电动工具贮存在儿童所及范围之外，并且不要让不熟悉电动工具或对这些说明不了解的人操作电动工具。电动工具在未经训练的用户手中是危险的。
- 5) 保养电动工具。检查运动件的安装偏差或卡住、零件破损情况和影响电动工具运行的其他条件。如有损坏，电动工具必须在使用前修理

好。许多事故由维护不良的电动工具引发。

- 6) 保持切削刀具锋利和清洁。保养良好的有锋利切削刃的刀具不易卡住而且容易控制。
- 7) 按照使用说明书以及打算使用的电动工具的特殊类型要求的方式，考虑作业条件和进行的作业来使用电动工具、附件和工具的刀头等。将电动工具用作那些与要求不符的操作可能会导致危险情况。
- 8) 保存此说明书。向使用该机器的使用者提供该说明书。如果将此机器出借给别人使用，也将此说明书一并借出。

5. 维修

- 1) 将您的电动工具送交专业维修人员，必须使用同样的备件进行更换。这样将确保所维修的电动工具的安全性。
- 2) 当维修时，仅使用有标示的零部件。
- 3) 按照本说明书中维修部分操作。使用未经授权的零件或未按该说明书中的指示操作可能引发触电的危险。

电木铣使用注意事项

⚠ 注意:电木铣开关关闭后，铣刀不会马上停止转动。

1. 工作时握着机器带有双重绝缘的把手上，工作时机器可能会碰到隐藏的或机器自身的电线。碰到带电的电线将会导致裸露的金属部分带电，从而引起操作者触电。
2. 始终紧紧地握住该机器的把手以防止启动机器时引起的反扭力带来的伤害。
3. 不要将机器放置在颠倒的或水平的位置上使用。电机可能会由于没有按照说明正确的装配而从底座里掉落。
4. 拧紧机器夹头以防止铣刀滑落。如果夹头没有拧紧，铣刀很可能在使用过程中分离出来，从而导致严重的人身伤害。
5. 无铣刀装入的情况下，不要拧紧夹头。
6. 用夹钳或其它方法将工件固定在平稳的台面上，将工件固定好。用手或身体支撑工件是不稳定的，且可能导致失控。
7. 不要用手或腿支撑欲切割的工件。支撑好并夹紧工件对切割质量和机器控制有很重要的作用。
8. 始终保持挡灰板清洁并放置原处。

9. 启动电机前保持警觉并清扫电木铣操作面上的障碍物。机器运行中保持切割表面的清洁，避免有异物阻碍工作。
10. 检查确保电线在操作过程中不会造成干扰。
11. 电木铣开启之前确保切割铣刀不会与工件表面接触。铣刀必须在到达全速后才能接触工件。
12. 当电木铣电机运转时不要用手直接触摸铣刀，避免人身伤害。
13. 当贯穿切割时，在工件下方为电木铣铣刀提供清洁。
14. 保持切割恒力。不要使电机过载。
15. 仅使用没有缺口和破裂的锋利的铣刀。钝的铣刀会引起堵转并灼伤工件。
16. 始终不要使用直径超过89mm的铣刀装在该机器上操作。
17. 使用为该机器设计的铣刀。不要使用直径比靠模板孔径大的铣刀，避免严重人身伤害。
18. 徒手操作时不应使用大尺寸的铣刀。若使用电木铣台，大铣刀仅用于边缘操作之用。
19. 使用靠模板前确保铣刀被安置在靠模板的中心以防止人身伤害或损坏已完成的工件。
20. 切割完成关闭电木铣，等该机器完全停止转动，将机器从被加工工件中移出。
21. 放下电木铣前保证电机完全静止。切断电源后，切割铣刀仍会滑行。
22. 仅使用对工件安全且能保护铣刀的电木铣台。使用那些经过标准鉴别的与该特殊电木铣合适的电木铣台。否则，会导致严重的人身伤害。
23. 仅使用携带方便，可开关控制的电木铣台。若使用不安全的电木铣台可能导致严重的人身伤害。
24. 任何调节或更换铣刀前，拔掉电源插座。
25. 使用过后，若要更换夹头或铣刀，不要用手直接安装，使用提供的扳手操作。切割产生的热可能造成灼伤。



警告：电木铣工作时产生的粉尘可能含有致癌或对人体有害的化学物质。例如：

- 油漆中含的铅。
- 砷和铬与木材起反应后也会产生有毒物质。

为了减少这些有毒的化学物质对人体的伤害，要尽量保证在通风的环境下工作，并且工作时配戴合格的安全保护装置。

配备

- 扳手 1个
- 导尺及导尺附件 1套

在某些国家或某些特殊的机型，其所提供的配备，可能与以上所给的资料稍有出入。

操作说明

1. 插入插头前，必须检查供电电压是否与铭牌数据相符！

2. 开关的操作

⚠ 注意：

- 在插入工具的电源插头之前，请确保开关处于关闭状态。
- 在开关启动之前，请确保轴锁是松开状态。
- 启动机器时应牢牢握住机器把手以抵制机器开机时的反冲力。

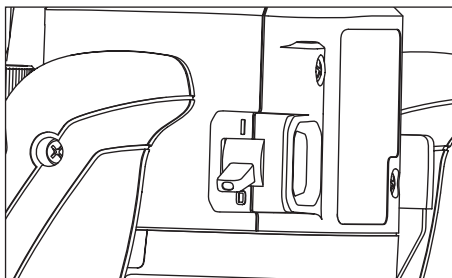

启动机器时，请将开关拨杆拨到“Ⅰ”的位置。要停机时，将开关拨杆拨到“O”的位置。

3. 铣刀选择

该电木铣配有1/2英寸的夹头，相应地使用刀柄直径为1/2英寸的铣刀。

⚠ 警告：根据不同的铣刀尺寸，参照说明书上面的速度选择表选择合适的速度。不按此规定操作可能导致机器失控，从而造成严重的人身伤害。

4. 安装/拆卸铣刀

安装铣刀

- 1) 关闭机器，从插座上拔出插头。
- 2) 将机器沿着夹头朝上的方向放置。
- 3) 按压轴锁按钮，锁住电机输出轴，使其不可转动。
- 4) 用扳手逆时针旋转夹头螺母松动夹头。

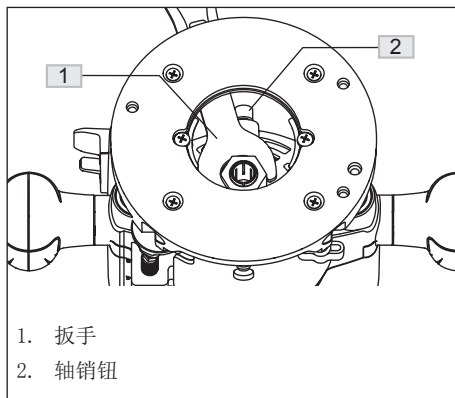

- 5) 装入铣刀，推动铣刀直到铣刀刀口与夹头表面相距3mm到6mm左右位置。为确保铣刀的柄部被牢固夹紧，柄部必需插入夹头内最少16mm深。
- 6) 铣刀安装到位后，按住轴锁按钮，用扳手顺时针旋转夹头螺母直到铣刀被夹头夹紧。

⚠ 警告：拧紧夹头螺母可防止铣刀滑落。若夹头螺母未拧紧，铣刀会在使用过程中掉落，导致严重的人身伤害。

⚠ 警告：无铣刀装入时，不要拧紧夹头螺母，以防止损坏机器。

⚠ 警告：铣刀装完后，请转动一下电机轴，以确保轴锁已松开，否则会导致严重的机器损坏。

7) 拆卸铣刀

按照以上相反步骤拆卸铣刀。

注意：不要敲击夹头来释放铣刀。使用后，铣刀若被卡住，松一下夹头螺母直到铣刀掉落。

⚠ 警告：机器不使用时要拆卸掉铣刀。铣刀装在机器上可能会引起突发事件，造成严重的人身伤害。

⚠ 警告：拆卸铣刀后，请转动一下电机轴，以确保轴锁已松开，否则会导致严重的机器损坏。

5. 调节深度

- 1) 关闭机器，将插头从插座中拔出。
- 2) 将机器放置在平面上。松开锁紧扳柄，降低机体，使刀头正好接触到平面。用锁紧扳柄将机器锁住。手按住锁定轴，快速降低深度调节旋钮高度，直至与跳位盘接触。然后将深度调节旋钮上升到需要切割的深度（深度调节旋钮与跳位盘之前的距离），松开锁定轴。此时可以松开锁紧扳柄，将机器下压到深度调节旋钮与跳位盘接触，锁紧机器，即可得到预设的切割深度。可以通过机壳上的刻度（每一格为1mm）来检查深度调节旋钮的行程。如果需要对切割深度进行微调，可以通过旋转深度调节旋钮来进行。

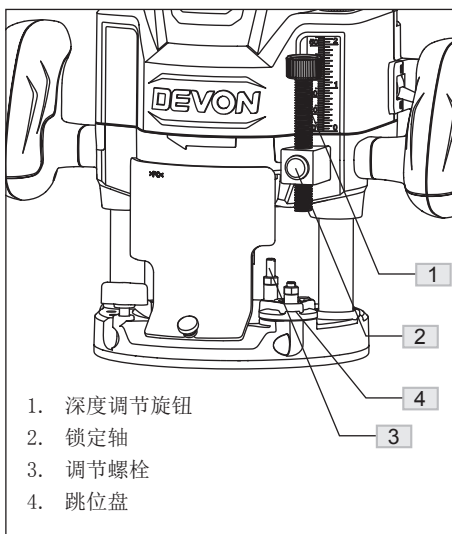

6. 旋钮

可以通过旋转旋钮，可以调节机体的上限位置。

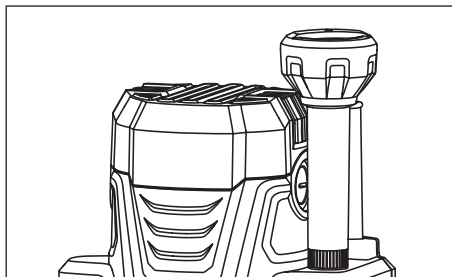

7. 导尺

该导尺用于刨削操作中辅助之用， 例如：装饰边缘、直边刨削、清理凹槽及刨槽打孔等。
将导尺杆直接插入导尺槽内，调整到合适位置，用导尺锁定钮将其锁定。
若使用中心定位器铣圆时，导尺需要反着安装。

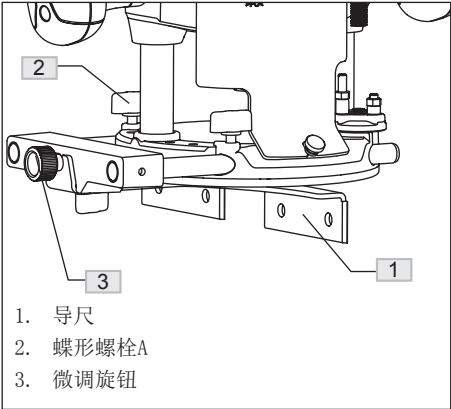

8. 导轮组

导轮组主要用于曲线切削。使用时导轮要紧贴着曲面以保证切削精度。

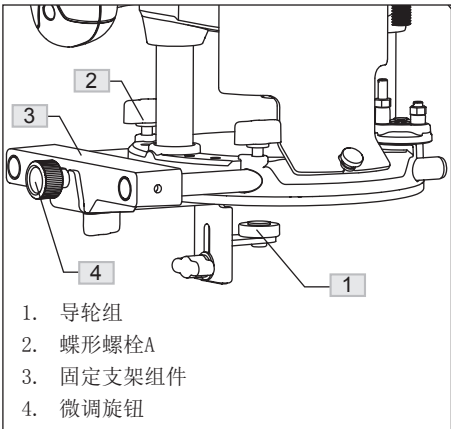

9. 底板导轮组

当工件与底板的接触面较窄时，使用底板导轮组可用效地保证机器的平衡，从而保证切削精度。
使用时，用螺栓将底板导轮组连接到底板相应的位置。底板导轮组在底板上有两个安装位置，这两个安装位置中心180° 对称。

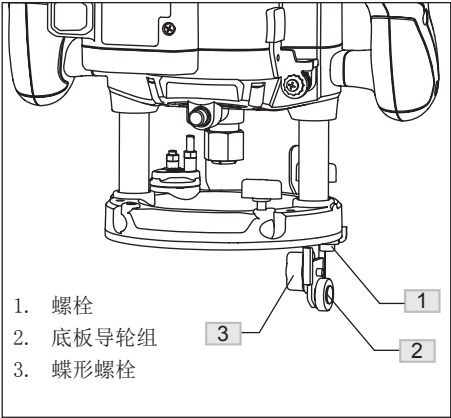

10. 电子调速(仅针对1324-18-12E)

根据铣刀的尺寸及被加工工件的材质坚硬程度，将机器调至相适应的速度，使操作完美并延长铣刀寿命。
通过旋转调速旋钮来升高或降低电机转速。向左旋，从“1”开始，加速；向右旋，减速。

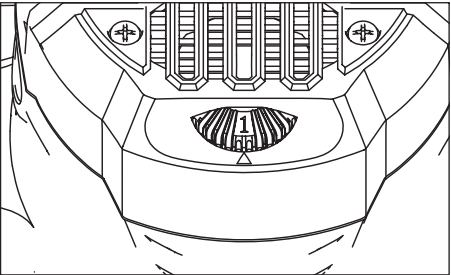

⚠ 警告：操作前遵循该说明书中的安全指示。否则，可能导致严重的人身伤害。

转速选择表	
不要超过该铣刀转速	
切割铣刀直径	调速档位选择
25毫米	6
30-35毫米	4-5
40-45毫米	2-3
50-55毫米	1-2

当使用直径过大的铣刀（直径大于等于25毫米）或沉重的铣刀时，应降低机器旋转速度，保证操作的安全性，同时也能改善切割效率。

旋钮设定	转速（转/分钟）	实际应用
1	9000	有色金属、硬
2	11500	木、较大直径
3	14000	铣刀
4	17000	软木、塑料、
5	19500	较小直径铣刀
6	22000	

以上表格表明速度设定与切割实际操作间的关系。机器转速应根据操作者的经验、喜好及切割铣刀制造商的推荐进行精确设定。

⚠ 警告：如长时间低速使用机器，电机会发生过载，造成工具故障。

11. 靠模板

靠模板有几种用法：

- 加工一工件的复制品。
- 与模板合在一起使用，进行图案的装饰
- 反复切割形状

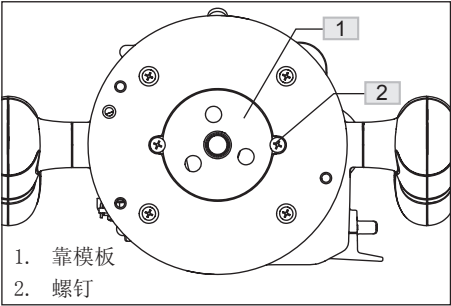

使用时，先松开底座上的螺钉，并将靠模板安装到底座上，然后再拧紧螺钉。

⚠ 注意：当靠模板安装好了之后再装铣刀。

12. 加工

- 装上导尺
- 将电木铣放置工件边缘，确保铣刀不会与工件碰触。
- 开动机器，是电机达到全速。
- 慢慢地将机器切入工件

⚠ 注意：若需要加工弧形，需要使用提供的导轮组。将导尺拆下，换上导轮组即可。

13. LED灯

该电木铣自配有2个LED工作灯，位于夹头的两侧，用于切割时照明之用。当将开关拨杆拉到1

的位置时，该工作灯将持续亮着。

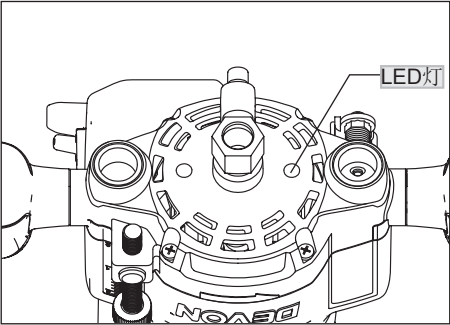

实际应用

1. 调整好切割深度，将电木铣放在工件上，只有导尺及底座与工件接触。
2. 开启电木铣，使机器完全达到已设定好的速度，注意不能让铣刀与工件接触。
3. 开始切割，将铣刀切入工件中。
4. 切割完成后，关闭电木铣。待铣刀完全停止转动再将其从工件中取出。
5. 从插座上拔掉插头，先将电木铣放置好，再检查工件的切割情况。

⚠ 警告：夹好工件，抓牢电木铣。否则，可能引起机器失控，造成严重的人身伤害。

⚠ 警告：当铣刀仍在转动时，从工件里移出铣刀可能损坏工件且导致失控，引发严重的人身伤害。用力按压工具并不会提高效率。

工具维护保养



警告：对电木铣进行维修检查之前，必须把插头拔离电源插座。

1. 检查安装螺钉。经常检查安装螺钉是否紧固稳妥。螺钉松开极易引起严重事故。
2. 定期检查线缆。电源线是特殊制备的，如发现损伤应立即委托 **DEVON** 授权的维修中心处理。此工具所用电源线为特殊结构，且勿擅自更换电源线，如需更换，请到 **DEVON** 授权的维修中心处理。
3. 保持通风槽清洁顺畅。经常清除尘埃、油污，严防杂物入内。
4. 更换碳刷。当碳刷磨损到一定长度器具将会

停止，一旦发生此情况，应及时更换碳刷，为了保证产品的安全性和可靠性，由经 **DEVON**[®] 授权的维修中心检查和更换碳刷，以防止触电和保证工具长期安全使用。

- 5. 必须由 **DEVON**[®] 授权的维修中心进行维修。只能使用 **DEVON**[®] 的配件、零件。
- 6. 清洁。避免使用造成塑料龟裂损坏的溶剂擦拭塑料零件。建议使用稍微沾湿了肥皂水的柔布。
- 7. 避免工具受到震荡、撞击或油脂影响。

 请勿让马达淋到水，禁止将整个机身投入水中，以免引起马达故障及触电事故！件。建议使用稍微沾湿了肥皂水的柔布。

环境保护



- 1. **DEVON**[®] 的包装可以百分之百进行回收再

生处理。

- 2. 报废的电动工具和附件中含有大量有价值的原材料及合成材料，同样可以进行再生回收。
- 3. 磨屑或切割时所产生的粉尘中会包含有害物质因而不应作为普通垃圾倾倒，而应交给特殊垃圾回收站处理。

服务

- 1. 工具需要保修时，请自行送至当地特约维修中心，并提供有效保修卡及购机发票原件，遗失保修卡恕不补发。
- 2. 由于正常磨损、过载或不当使用而导致的损坏，不在保证范围内。

附：一般故障及排除方法

故障	原因	排除方法
通电后电机不转	插头未插入电源插座	将插头插入电源插座
	电刷与换向器表面不触	更换碳刷
	刷握内进灰，碳刷卡住	取出碳刷，清理刷握和碳刷表面粉尘
铣刀不能装入	铣刀刀柄尺寸不对	选择刀柄尺寸与夹头规格相同的铣刀
碳刷火花大	刷握进灰，碳刷运动受阻	取出碳刷，清理刷握和碳刷表面粉尘
切割后工件表面不光滑	铣刀变钝	更换锋利的铣刀
	切割速度设置不对	参照“速度选择表”，选择合适的铣刀速度

DESCRIPTION OF THE TOOL

OPERATING CONTROL



The power tool is intended for trimming on the wood or plastic; also the machine can be used to millslot, carve and dig holes.

Read, understand and follow all safety rules and instructions before using this tool.

1. MAIN PARTS

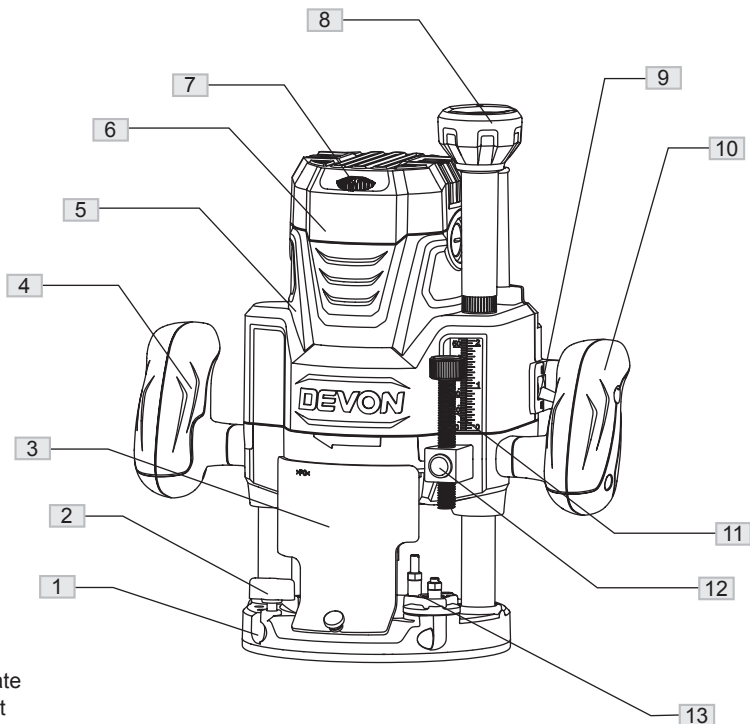

- 1. Base Plate
- 2. Lock Bolt
- 3. Chip Shield
- 4. Left Handle
- 5. Motor Housing
- 6. Motor Top Cover
- 7. Electronic Variable Speed Control(only for 1324-18-12E)
- 8. Adjusting Knob
- 9. Rocker Switch
- 10. Right Handle
- 11. Depth Adjusting Knob
- 12. Lock Pin
- 13. Turntable
- 14. LED Worklight
- 15. Plunge Lock Lever
- 16. Spindle Lock Button

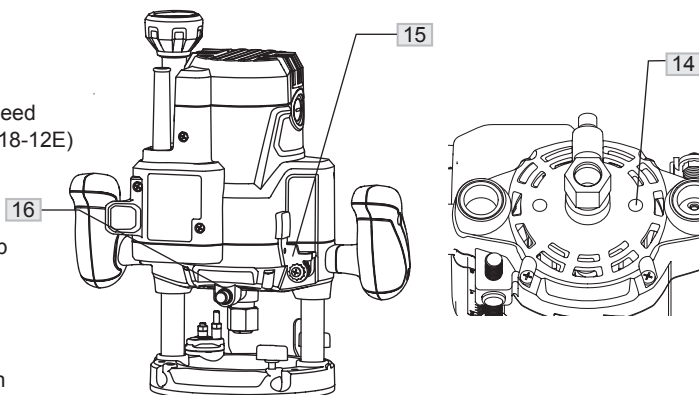

2. TOOL SPECIFICATIONS

Model	1324	1324-18-12E
Voltage (V)	220	220
Frequency (Hz)	50	50
Power (W)	1750	1880
No load speed (/min)	22000	9000-22000
Depth adjustment	Y	Y
LED worklight	Y	Y
Electronic Variable Speed Control	N	Y
Stroke height(mm)	0-60	0-60
Sub-base diameter (mm)	160	160
Weight (Kg)	5.7	5.7
Protection Class	□/II	□/II

NOTE 1: Due to **DEVON**'s continuing program of development, the specifications herein are subject of change without prior notice.

NOTE 2: The values given are valid for nominal voltages [U] of 220 V. For lower or higher voltages and models for specific countries, these values can vary.

GENERAL SAFETY RULES

 **WARNING:** Read all instructions. Failure to follow all instructions listed below may result in electric shock, fire and/or serious personal injury.

The term "power tool" in all of the warnings listed below refers to your mains operated (corded) power tool or battery operated (cordless) power tool.

SAVE THESE INSTRUCTIONS

1. WORK AREA SAFETY

- 1) Keep your work area clean and well lit. Cluttered or dark areas invite accidents
- 2) Do not operate power tools in explosive environments, such as in the presence of flammable liquids, gases, or dust. Power tools create sparks, which may ignite the dust or fumes.
- 3) Keep children and bystanders away while operating a power tool. Distractions may cause you to lose control.

2. ELECTRICAL SAFETY

- 1) Power tool plugs must match the outlet. Never modify the plug in any way. Do not use any adapter plugs with grounded power tools. Unmodified plugs and matching outlets will reduce the risk of electric shock.

- 2) Avoid body contact with grounded surfaces, such as pipes, radiators, ranges, and refrigerators. There is an increased risk of electric shock if your body is grounded.
- 3) Do not expose power tools to rain or wet conditions. Water entering a power tool will increase the risk of electric shock.
- 4) Do not abuse the cord. Never use the cord for carrying, pulling, or unplugging the power tool. Keep the cord away from heat, oil, sharp edge, or moving parts. Damaged or entangled cords increase the risk of electric shock.
- 5) When operating a power tool outdoors, use an extension cord suitable for outdoor use. Use of a cord suitable for outdoor use reduces the risk of electric shock.
- 6) If operating a power tool in a damp location is unavoidable, use a residual current device (RCD) protected supply. Use of an RCD reduces the risk of electric shock.

3. PERSONAL SAFETY

- 1) Stay alert, watch what you are doing and use common sense when operating a power tool. Do not use a power tool while tired or under the influence of drugs, alcohol, or medication. A moment of inattention while operating power tools may result in serious personal injury.

- 2) Use safety equipment. Always wear eye protection. Safety equipment, such as dust mask, non-skid safety shoes, hard hat, and hearing protection, when used for appropriate conditions, will reduce personal injuries.
- 3) Avoid accidental starting. Make sure that the switch is in the "OFF" position before plugging the tool into an electrical outlet. Carrying power tools with your finger on the switch or plugging in power tools that have the power switch "ON" invites accidents.
- 4) Remove any adjusting key or wrench before turning the power tool on. A wrench or key left attached to a rotating part of the power tool may result in personal injury.
- 5) Do not overreach. Keep proper footing and balance at all times. This enables better control of the power tool in unexpected situations.
- 6) Dress properly. Do not wear loose clothing or jewelry. Keep your hair, clothing, and gloves away from moving parts. Loose clothes, jewelry, or long hair can be caught in moving parts.
- 7) If devices are provided for the connection of dust extraction and collection facilities, make sure that these are connected and properly used. Use of these devices can reduce dust-related hazards.
- 8) Use clamps or another practical way to support and secure the workpiece to a stable platform. Holding the work by hand or against your body leaves it unstable and may lead to loss of control.
- 9) Do not use on a ladder or unstable support. Stable footing on a solid surface enables better control of the power tool in unexpected situations.
- 10) Keep handles dry, clean, and free from oil and grease. Slippery hands cannot safely control the power tool.
- 11) Always wear safety glasses with side shields. Everyday glasses may have impact resistant lenses, but they are not safety glasses. Following this rule will reduce the risk of eye injury.
- 12) Protect your lungs. Wear a face or dust mask if the operation is dusty. Following

this rule will reduce the risk of serious personal injury.

- 13) Protect your hearing. Wear hearing protection during extended periods of operation. Following this rule will reduce the risk of serious person injury.

4. POWER TOOL USE AND CARE

- 1) Do not force the power tool. Use the correct power tool for your application. The correct power tool will do the job better and more safely at the rate for which it was designated.
- 2) Do not use the power tool if the switch does not turn it ON and OFF. Any power tool that cannot be controlled with the switch is dangerous and must be repaired.
- 3) Disconnect the plug from the power source and/or the battery pack from the power tool before making any adjustments, changing accessories, or storing power tools. Such preventive safety measures reduce the risk of starting the power tool accidentally.
- 4) Store idle power tools out of the reach of children and do not allow persons unfamiliar with the power tool or these instructions to operate the power tool. Power tools are dangerous in the hands of untrained users.
- 5) Maintain power tools. Check for misalignment or binding of moving parts, breakage of parts and any other condition that may affect the power tool's operation. If damaged, have the power tool repaired before use. Many accidents are caused by poorly maintained power tools.
- 6) Keep cutting tools sharp and clean. Properly maintained cutting tools with sharp cutting edges are less likely to bind and are easier to control.
- 7) Use the power tool, accessories, blades, etc. in accordance with these instructions and in the manner intended for the particular type of power tool, taking into account the working conditions and the work to be performed. Use of the power tool for operations different from those intended could result in a hazardous situation.
- 8) Save these instructions. Refer to them frequently and use them to instruct others who may use this tool. If you lend this tool to someone else, also lend them these instructions.

5. SERVICE

- 1) Have your power tool serviced by a qualified repair person.
- 2) When servicing a power tool, use only identical replacement parts.
- 3) Follow instructions in the Maintenance section of this manual. Use of unauthorized parts or failure to follow Maintenance instructions may create a risk of shock or injury.

ADDITIONAL SAFETY RULES FOR ROUTER

 **CAUTION:** Router bits coast after the router is switched off.

- 1) Hold the tool by insulated gripping surfaces (handles) when performing an operation where the cutting tool may contact hidden wiring or its own cord. Contact with a "live" wire will make the exposed metal parts of the tool "live" and shock the operator.
- 2) Maintain a firm grip on the router with both hands to resist torque upon starting the router.
- 3) Do not hold the router by hand for use in an upside-down or horizontal position. The router motor can separate from the base if it is not properly attached according to the instructions.
- 4) Tighten the collet/nut securely to prevent the router bit from slipping. If the collet/nut is not securely tightened, the router bit may detach during use, causing **serious personal injury**.
- 5) Never tighten the collet/nut without a router bit installed in the collet /nut.
- 6) Use clamps or other practical ways to secure and support the workpiece to a stable platform, and hold the workpiece rigidly in position. Holding the workpiece by hand or against your body is unstable and may lead to loss of control.
- 7) Never hold the piece being cut in your hands or across your legs. It is important to support and clamp the workpiece properly in order to minimize body exposure, bit binding, and loss of control.
- 8) Always keep the chip shield clean and in place.

- 9) Stay alert and clear the router cutting-bit path of any obstructions before starting the motor. Keep the cutting area clear of all foreign objects while the router motor is running.
- 10) Check to see that the cord will not "hang up" during routing operations.
- 11) Make sure that the router bit is not in contact with the workpiece before the switch is turned on. The bit must always be running at full speed before contacting the workpiece.
- 12) Keep hands clear of the router bit when the router motor is running to prevent personal injury.
- 13) Provide clearance under the workpiece for the router router bit when through-cutting.
- 14) Keep cutting pressure constant. Do not overload the motor.
- 15) Use only sharp router bits that are not chipped or cracked. Blunt router bits will cause stalling and can burn the workpiece.
- 16) Never use this router motor with a router bit larger than 3-1/2-inches in diameter.
- 17) Always use router bits that are designed for this router. Never use router bits that are larger in diameter than the opening in the router sub-base. Decrease serious personal injury.
- 18) Do not use large router router bits for freehand routing. If using a router table, large bits should be used for edging only.
- 19) Be sure the router bit is centered in the template guide prior to template-guide applications to avoid personal injury or damage to finished work.
- 20) Turn the router motor OFF after completing a cut, and let it come to a complete stop before removing the router from workpiece.
- 21) Let the router motor come to a complete stop before putting the router down. Router bits coast after the power is turned off.
- 22) Only use router tables that conform to safe woodworking practices and offer proper guarding for the router bit. Use router tables that are UL classified and identified as suitable for use with this specific router model. Failure to comply could result in serious personal injury.
- 23) Only use router tables with on-board, switch-controlled receptacles. Failure to use router

tables with all the appropriate safety features could result in serious personal injury.

24) Disconnect the tool from the power source before making any adjustments or changing router bits.

25) Be careful not to touch the collet/nut or router bit with your hands or fingers if you are changing a bit immediately after use. The heat buildup from cutting could cause severe burns. Always use the wrench provided.



WARNING: Some dust created by power Cutting contains chemicals known to cause cancer, birth defects or other reproductive harm. Some examples of these chemicals are:

- lead from lead-based paints
- Arsenics and chromium from chemically reacted lumber.

Your risk from these exposures varies, depending on how often you do this type of work. To reduce your exposure to these chemicals: work in a well ventilated area, and work with approved safety equipment.

ACCESSORIES

- Spanner 1 pc
- Roller guide and Accessories 1 UNIT

Be sure to check the accessories as it is subject to change by areas and models.

OPERATION

1. POWER SUPPLY

The power tool supply must match the nameplate date.

2. TRIGGER SWITCH AND LOCK-ON BUTTON FOR ROUTER

To start /stop Router



CAUTION:

- 1) Connect the plug of the power cord to a standard, household power outlet.
- 2) Start the router by squeezing the ON/OFF trigger switch.
- 3) To stop the router, release the ON/OFF trigger switch.
- 4) To lock the ON/OFF trigger switch in the "ON" position, press trigger switch and, while holding it "ON," press in the lockon button located on the one side of the handle.
- 5) The lock-on button allows the operator to keep the router running without squeezing the trigger switch. This is useful for continuous routing applications.
- 6) To release the power lock-on button, press and release the trigger switch. This will turn

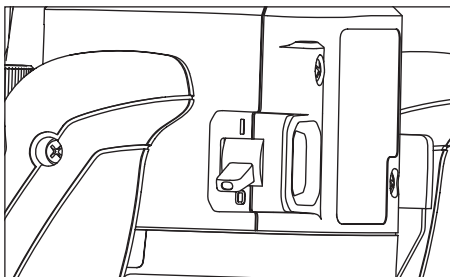

3. SELECTING THE ROUTER BIT

This router comes with 1/2-in. collets/nuts that accept 1/2-inch-diameter shanked router bits, respectively.



WARNING: Refer to the Variable Speed Selection Chart located on top cap of the router motor for the maximum speeds to use with various cutting-bit diameters. Failure to follow these instructions could cause loss of control of the router in the workpiece, causing possibly serious personal injury.

4. INSTALLING AND REMOVING THE ROUTER BIT

Installing the router bit

1. Turn router motor off and unplug it from the power source.
2. Place the router motor upside down on its top cap with the collet/nut pointing up.
3. Press the spindle-lock button to engage and lock the spindle shaft and collet/nut.
4. Place the wrench on the collet/nut, and turn it counter-clockwise to loosen collet/nut slightly to accept the cutting-bit shank.
5. Insert the router bit shank into the collet/nut assembly as far as it will go, then back the shank out until the cutters are approximately 1/8 to 1/4- inch away from the face of the collet/nut. To ensure proper gripping of cutting-bit shank and minimize run-out, the shank of the router bit must be inserted into the collet/nut at least 5/8-inch.
6. With the router bit inserted and the spindle lock button pressed in to engage the shaft, place the wrench on the collet/nut and turn it clockwise until the router bit and the collet/nut are firmly tightened.

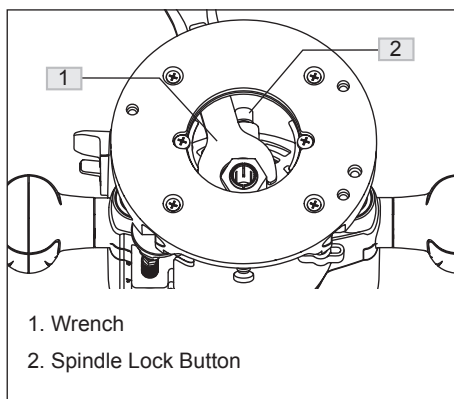

WARNING: Tighten the collet/nut securely to prevent the router bit from slipping. If the collet/nut is not securely tightened, the router bit may detach during use, causing serious personal injury.

CAUTION: To prevent damage to tool, do not tighten the collet/nut without a router bit installed.

REMOVING THE ROUTER BIT

Reverse the upper steps.

WARNING: Always remove router bits from the collet/nut when the router is not being used. Leaving bits installed could result in an accident causing serious personal injury.

5. TO ADJUST DEPTH

- 1) Turn the router motor off and unplug the router from the power source.
- 2) Place the router, with the router bit installed, on a flat, level surface with the back of the fixed base facing you.
- 3) Open the Router Clamp. Press in Coarse Adjustment Knob, and lower/upper the router motor into the base. There are three depth selections. Turn Fine Adjustment Dial, the precision on the motor is to 1mm. and 0.5mm on the Fine Adjustment Dial.
- 5) Turn the Fine Adjustment Dial counterclockwise to lower the bit to the desired depth of cut. Turn the dial clockwise to raise the router bit.
- 6) Through the casing on the scale (each case to 1 mm) to check the depth adjustment knob trip.

If you need to adjust cutting depth, can spin depth adjusting knob .

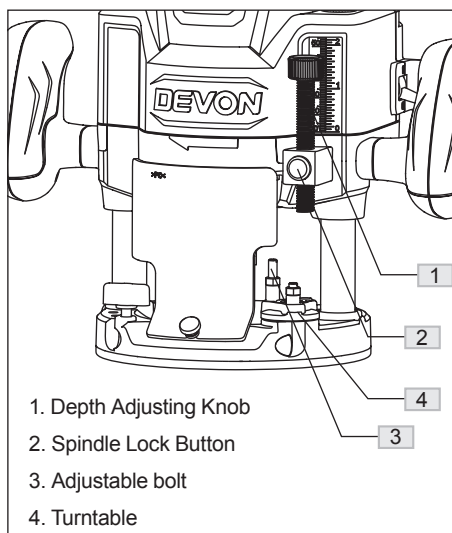

6. Knob

Through the rotating knob, you can adjust the body's upper limit position.

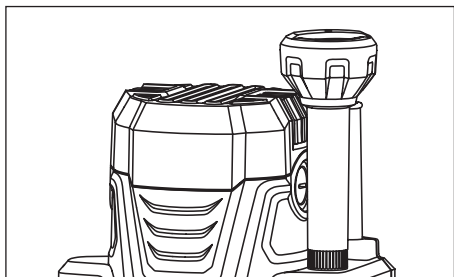

7. EDGE GUIDE

This edge guide can be used as an aid in routing applications such as decorative edging, straight edge planning and trimming grooving, dadoing and slotting.

To attach the edge guide, simply insert the edge guide rods into edge-guide mounting slots, adjust it to the desired position, and lock down with the edge-guide locking knobs. If the center localizer is needed, the edge guide should be assembled reverse the normal method shown in the figure.

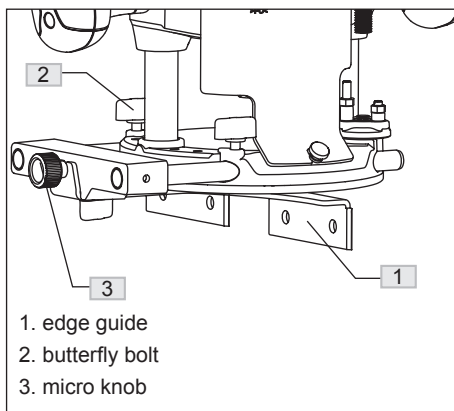

8. GUIDE WHEEL SET

Mainly used for curve cutting, When using wheel to close to the surface to ensure the cutting precision.

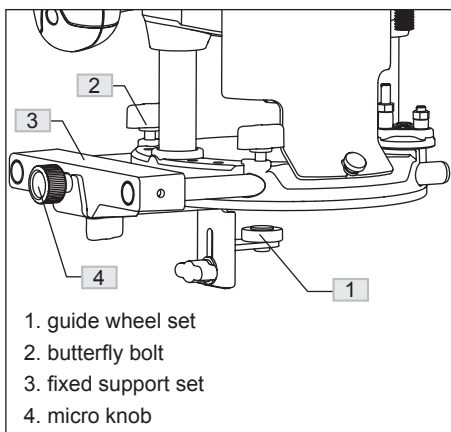

9. BASEPLATE GUIDE WHEEL SET

When the workpiece and the baseplate of the contact surface is narrow, the use of the baseplate guide wheel set can effectively guarantee the balance of the machine, so as to ensure cutting precision. Baseplate guide wheel set has two installation position, the two installation position center is symmetrical.

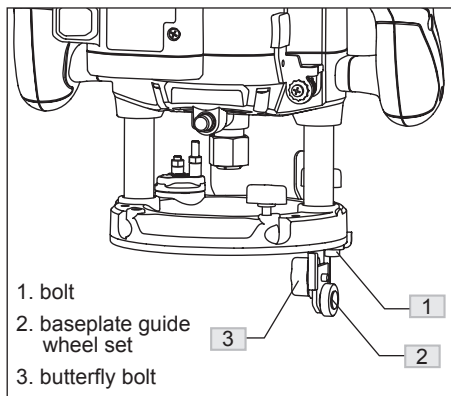

10. ELECTRONIC VARIABLE SPEED CONTROL(only for 1324-18-12E)

The electronic speed control feature allows router motor speed to be matched to cutter size and workpiece-material hardness for an improved finish and extended bit life.

Speed changes are made by rotating the Speed Control Dial to the "LEFT," starting at "1," to increase the speed and to the "RIGHT" to decrease the speed, as indicated on the Dial.

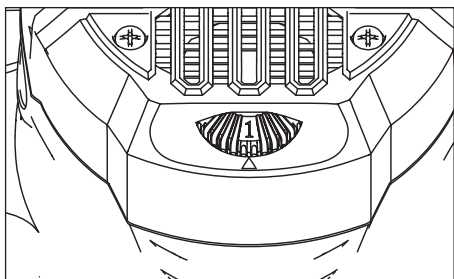

- In conjunction with a template, producing decorative features
- Repetitive cutting shapes
- When using, to loosen the base of the screw, and will depend on template guide installation base plate, then tighten the screws up.

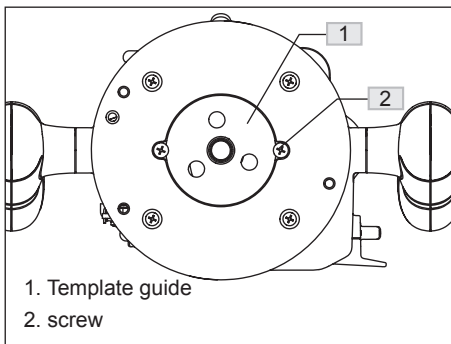

NOTE: Be sure to insert the router bit after the template guide has attached firmly.

12. EDGE ROUTING

- Clamp a straight edge to the workpiece as a guide.
- Place the router on the edge to the workpiece without the bit contacting the workpiece.
- Turn router on and let the motor build up to full speed.
- Gradually feed the bit into the workpiece using the clamped straight edge as a guide.

NOTE: If want to routing arc, the roller guide (supplied) is needed. Use the roller guide attached on the edge guide.

13. LED WORKLIGHT

The router motor has 2 built-in worklights located around the collet/nut for high visibility of workpiece when cutting. These lights are always "ON" when the trigger switch is in the "ON" position.

WARNING: Before operating the router follow all safety instructions in this manual. Failure to do so could result in serious personal injury.

Variable Speed Selection Chart	
Never exceed these bit speed	
Router –Bit Diameter	Max. Speed
Up to 25mm	6
30-35mm	4-5
40-45mm	2-3
50-55mm	1-2

Reduce the speed when using extra large bits (1-in or more in cutting diameter) or heavy router bits. Changing the router's rate of feed can also improve the quality of the cut.

Dial Setting	rpm	Application
1	9000	Non-ferrous
2	11500	metal, hardwoods, larger diameter router bits
3	14000	
4	17000	Softwoods, plastics, countertops, smaller diameter router bits
5	19500	
6	22000	

The speed charts above indicate the relationship between the speed setting and the cutting application. Exact settings are determined through operator experience and preference and by recommendations by the cutting-bit manufacturer.

WARNING: In the low speed under long time use machine, motor occur overload, cause tool failure.

11. TEMPLATE GUIDE

The template guide can be used in various ways:

- Producing duplicates of a particular design of an original shape

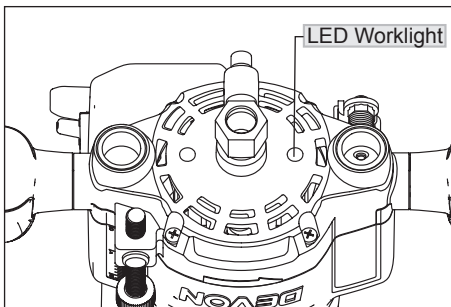

APPLICATION

1. With the depth-of-cut set, tilt the router and place it on the workpiece with only the leading edge of the sub-base contacting workpiece.
2. Turn the router motor "ON" and allow the router motor to reach the selected speed, being careful not to allow the router bit to contact the workpiece.
3. To begin the cut, gradually lower the router until the sub-base is level with the workpiece to feed the router bit into the workpiece.
4. When the cut is complete, turn the router "OFF" and allow the router bit come to a complete stop before removing it from the workpiece.
5. Unplug the router from the power source, place the router upside down on the worktable, and inspect the finished cut in the workpiece.

⚠ WARNING: Always securely clamp the workpiece in place, and keep a firm grip on the router base with both hands at all times. Failure to do so could result in loss of control, causing possibly serious personal injury.

⚠ WARNING: Removing the router bit from workpiece while it is still rotating could damage the workpiece and result in loss of control, causing serious personal injury.

TOOL MAINTENANCE



⚠ WARNING: Before any work on the machine itself, unplug the saw from the power source.

1. Inspect bolts periodically. If the bolts loosen, tighten them immediately, or will result in serious accident.
2. Inspect tool cords periodically. The cord is special prepared, if damaged, have repaired at your nearest Authorized **DEVON** Service Center. This tool was used with the power cord as a particular structure, don't replace the power cord without authorization, such as replacement, please go to the Authorized **DEVON** Service Center.
3. Keep the vents clean. Clean all parts of the tool, clean dust periodically. To prevent debris from entry.
4. Replace the carbon brush when the carbon brush is worn out in certain length and motor stops running. All maintenance should be carried Out by Authorized **DEVON** Service Center.
5. All service MUST only be performed by Authorized **DEVON** Service Center. ALWAYS use only **DEVON** accessories that are recommended for this tool.
6. Cleaning. Avoid the use of plastic cracks caused by damage to the solvent. Use clean cloths and mild soap to remove dirt, dust, etc.
7. Avoid the tool vibration or impact, and keep it from oil and grease.

⚠ WARNING: Do not allow the water entering the motor and the tool full immersed in the ware, which will result in motor malfunction and electric shock.



- 1. Tool, accessories and packaging should be sorted for environment-friendly recycling.
- 2. Power tools and accessories at the end of their service life still contain large amounts of valuable raw materials and plastics which can likewise be fed back into a recycling process.
- 3. Some dust created by working contains harmful chemicals must be collected by special garbage re- cycle site.

- 1. In case of guarantee, repair or purchase of replacement parts, always contact the qualified service center. And supplied with the efficient service card and invoice.
- 2. It is without the scope of guarantee when the tool was normal wear, overload or improper use of damage.

Problem Shooting

Problems	Reasons	Ways to Solve The Problems
The router does not work	Plug is not plugged into the power source	Plug the cord into the power source
	The carbon brushes have worn out completely	Open the brush cap, and replace the old brushes with suitable new brushes
Bit can not be installed	Bit size is inappropriate for the collet/nut	Use the right specifications of Cutting-Bit
The surface of the workpiece is not smooth after cutting	The bit is dull	Change to a sharp bit
	Routing at an inappropriate bit speed	Refer to “variable speed selection chart” in the manual, and select an appropriate bit speed

POWER, IN YOUR HANDS

POWER, IN YOUR HANDS

保修卡

Warranty Card

合格证 PRODUCT CERTIFICATION	
制造商: 南京德朔实业有限公司 地址: 江苏南京江宁经济技术开发区将军大道159号 销售商: 泉峰(中国)工具销售有限公司	检验员 

全国统一售后服务电话
 **400-828-9076**

重要提示

机身铭牌上的9位编码是厂家判断机器真伪及提供售后服务的重要凭证, 如您购买了编码无法辨识的机器, 可能无法得到厂家正常的保修服务

保修服务说明:

- 工具需要维修时, 请送至当地大有授权维修中心或寄至泉峰售后服务部, 产品保修期以购机发票/收据原件上的日期起算。
- 仅对存在质量缺陷的产品给与免费维修或免费换新, 其前提是经大有授权维修中心证明其故障是由于材料或制造缺陷所造成的, 并处于保修期内。
- 保修期及保修条款根据工具的种类而定:
 1. 交流工具:
 - 1.1. 整机保修6个月或者转子换向器直径磨损量在0.2毫米以内, 以先到为准。
 2. 直流工具:
 - 2.1. 12V产品: 机身保修12个月, 电池、充电器为12个月内包换。
 - 2.2. 14V以上产品: 机身保修6个月, 电池、充电器为6个月内包换。
 3. 光电工具:
 - 3.1. 激光测距仪: 保修24个月。
 - 3.2. 其他光电产品: 保修12个月。
- 保修不包括:
 1. 任何自然磨损以及正常使用时所发生损耗, 如气缸、齿轮、O形圈、转子换向器直径磨损量超过0.2毫米、碳刷、轴承、开关、电子线路板、电源线等。
 2. 由于不遵守操作说明、不正确使用、异常的环境条件、不适当的操作条件、过载或缺乏足够的维护和保养所导致的工具故障。
 3. 自行或非大有授权维修点拆修的所导致的工具故障。
 4. 由于使用非原装大有配件而引起的缺陷。
 5. 经过改装或增加部件的工具。
 6. 随机附送的配件或者附件。
- **Quark** 系列产品定位于家庭DIY用户, 不能用于任何商业目的场合。如有违反, 厂家将不提供保修服务。
- 具体保修明细可查询大有官网: www.devon.com.cn

本资料内容如有变更, 恕不另行通知, 解释权属于公司。

如有 **DEVON 大有** 牌电动工具产品需要维修、保养和咨询服务，
请您与 **DEVON 大有** 特约维修中心联系。

售后服务官方QQ: 3051884030

售后服务邮箱: devon-afterservice@chervon.com.cn

售后服务咨询电话: 025-52786697、025-87159105

售后服务地址: 江苏省南京市江宁区将军大道159号，
德朔工业园，泉峰（工具）中国销售有限公司，
售后服务部

售后件寄回收件人: 客服1号

您也可选择您身边的授权维修网点享受售后服务。
关注大有官方微信，即可查询售后服务信息。



扫描并关注大有官方微信，
输入“售后”二字，即可
查询售后服务网点

泉峰(中国)工具销售有限公司

中国南京江宁经济技术开发区将军大道159号，211106

电话：025-52786697 传真：025-52788663

网址：www.devon.com.cn



全国统一售后服务电话

400-828-9076

本资料内容如有变更，恕不另行通知。

版次：13 发行日期：2017-4-10

DEVON®大有

中国南京江宁经济技术开发区将军大道159号

制造商：(外商独资)南京德朔实业有限公司

No.159 Jiang-Jun Rd., Nanjing Jiangning
Economic & Technical Development Zone.

Nanjing 211106, P.R.China

Tel: +86-25-52786666

Fax: +86-25-52127140

Http:// www.devon.com.cn